

ILLUSTRATED PARTS LIST SYSTEM 9029 - 1993-2000 DODGE 360 MAGNUM WAC

ASSY.	ITEM	UNIT	QTY	PART#	DESCRIPTION
1.0					Main Bracket Assembly
	1.1	ea	1	11123	Main bracket
	1.2	ea	1	13007	Back idler
	1.3	ea	1	14051	Idler bolt spacer
	1.4	ea	1	15161	1/4" x 1 1/4" NC flange lock HHCS
	1.5	ea	1	14129	Idler spacer
	1.6	ea	1	13007	Back idler
	1.7	ea	1	OEM	C/W Item 1.17
	1.8	ea	1	OEM	C/W Item 1.17
	1.9	ea	1	16218	VR7000 belt
	1.10	ea	1	14144	A/C line spacer
	1.11	ea	1	18150	VR7000 crankshaft pulley
	1.12	ea	1	14165	Pulley washer
	1.13	ea	1	15119	3/4" x 4" NF HHCS
	1.14	ea	1	34026	Fan spacer
	1.15	ea	1	15419	12mm x 80mm HHCS
	1.16	ea	1	26075	Tensioner
	1.17	ea	3	15008	8mm x 1.25 nut hex pl
	1.18	ea	3	15067	5/16" SAE washer
	1.19	ea	3	15399	8mm x 38mm stud
2.0				1231	Compressor Assembly
	2.1	ea	1	1202	VR7000 Compressor
	2.2	ea	1	92174	Inlet valve, integrated regulator, short
	2.3	ea	1	36037	Paper filter element
	2.4	ea	1	15029	1/4" NC Nylok nut
	2.5	ea	1	15038	1/4" SAE washer
	2.6	ea	1	36045	Filter cover
	2.7	ea	1	15374	1/4" NC threaded rod, 3" long
	2.8	ea	1	15221	1/4" NC hex nut
	2.9	ea	1	92039	VR7000 oil filter
	2.10	ea	1	92091	1/8" NPT scavenge orifice 90° elbow
	2.11	ea	1	58004	3 1/8" ID x 1/8" wide o-ring, Viton
	2.12	ea	2	22097	Cable clamp, 1/4"
	2.13	ea	1	50012	Connector 1/4" poly tube to 1/8" male NPT
	2.14	ea	1	50012	Connector 1/4" poly tube to 1/8" male NPT
	2.15	ea	1	50064	1/4" tube x 1/8" pipe 90° elbow
	2.16	ea	1	49035	3/4"-16 straight thread nipple
	2.17	ea	1	2035	Clutch, complete
	2.18	ea	1	35363	Temperature probe cable assembly
	2.19	ea	1	50060	Connector 1/2" SAE x 1/2" NPT

ILLUSTRATED PARTS LIST SYSTEM 9029 - 1993-2000 DODGE 360 MAGNUM WAC

ASSY.	ITEM	UNIT	QTY	PART#	DESCRIPTION
3.0				3041	Tank Assembly
	3.1	ea	1	92184	Main tank body
	3.2	ea	1	49033	1/4" NPT x 1/4"-37° JIC steel connector
	3.3	ea	1	36054	200 PSI safety valve
	3.4	ea	1	15385	Retaining ring
	3.5	ea	1	32033	Sight glass window
	3.6	ea	1	58008	1 15/16" x 3/32" wide o-ring, Viton
	3.7	ea	1	12202	Guard plate
	3.8	ea	1	50060	1/2" NPT x 1/2" SAE - 45° brass connector
	3.9	ea	1	48105	Scavenge screen barb assembly
	3.10	in	2	17090	1/4" silicone hose
	3.11	ea	1	37223	Scavenge tube, c/w nut assembly
	3.12	ea	1	58068	Compression spring
	3.13	ea	1	36036	Coalescing filter
	3.14	ea	1	36064	Tank rear cap seal
	3.15	ea	1	32156	Tank discharge cap
	3.16	ea	1	49045	Hollow hex plug, SAE #8 o-ring port
	3.17	ea	1	58066	4 1/4" x 1/8" wide o-ring, Viton
	3.18	ea	1	49058	Steel 90° elbow 1/8" NPT to 1/4" JIC
	3.19	ea	1	49059	Steel 1/8" NPT x 5/16" JIC
4.0				4043	Hose kit
	4.1	ea	1	17279	1/2" AQP x 66.0" hose, c/w 90° & 45° fittings
	4.2	ea	1	17390	1/4" HT x 77.5" hose
	4.3	ea	1	17280	1/2" AQP x 29.0" hose, c/w 90° fitting
	4.4	ea	1	17278	1/2" AQP x 48.0" hose
	4.5	ea	1	17299	5/16" HT x 79.5" hose
5.0				5054	Throttle Control Assembly
	5.1	ea	1	5039	Throttle control, mechanical
	5.2	ea	4	15457	1/4" x 5/8" NC bolt
	5.3	ea	4	15350	1/4" serrated lock washer
	5.4	ea	1	92147	Modified 1/4" tube to 1/8" NPT orifice 90°
	5.5	in	22	17334	1/4" poly tube, red
	5.6	in	33	17055	1/4" poly tube, black
	5.7	ea	1	12237	Throttle control mount bracket
	5.8	ea	1	15009	3/8" split lock washer
	5.9	ea	1	15026	3/8" x 1 1/4" NC HHCS
	5.10	ea	1	12193	Cable & coil bracket
	5.11	ea	1	32058	Cable clamp fitting
	5.12	ea	1	32070	Cable nipple
	5.13	ea	1	15405	8-32 x 1/4" SHCS
	5.14	ea	1	12195	Throttle pull
	5.15	ea	1	15335	1/4" nylon washer
	5.16	ea	1	15410	Hitch pin clip
	5.17	ea	1	50020	Connector elbow 1/4" poly tube to 1/8" NPT male
	5.18	ea	1	15182	5/16" x 1 1/4" NC HHCS
	5.19	ea	1	15058	5/16" lock washer

ILLUSTRATED PARTS LIST SYSTEM 9029 - 1993-2000 DODGE 360 MAGNUM WAC

ASSY.	ITEM	UNIT	QTY	PART#	DESCRIPTION
6.0				48141	Tank Brackets
	6.1	ea	4	15445	3/8" x 3 3/4" NC flange lock HHCS
	6.2	ea	4	15446	3/8" x 3/4" NC flange lock HHCS
	6.3	ea	4	15010	3/8" NC hex nut
	6.4	ea	4	15151	3/8" NC threaded rod 8.50" long
	6.5	ea	8	15044	3/8" SAE washer
	6.6	ea	8	15066	3/8" NC Nylok nut
	6.7	ea	2	22094	Top frame clamp
	6.8	ea	2	22093	Bottom frame clamp
	6.9	ea	2	32148	Tank cradle spacer
	6.10	in	2	22092	Tank cradle
	6.11	ea	2	22095	Cable assembly 13.25" long
	6.12	ea	4	15066	5/16" NC nut hex
	6.13	ea	4	15067	5/16" SAE washer
7.0				48136	Cooler Assembly
	7.1	ea	1	92142	Heat exchanger (cooler)
	7.2	ea	1	12191	Cooler bracket
	7.3	ea	1	22099	Backing bar
	7.4	ea	8	22026	Hose clamp, HS28
	7.5	ea	1	17286	Hose, cooler outlet to connector
	7.6	ea	2	17277	Hose connector
	7.7	ea	1	17285	Hose, connector to rad
	7.8	ea	1	17284	Hose, cooler inlet to connector
	7.9	ea	1	17287	Hose, connector to engine
8.0					Electrical Assembly
	8.1	ea	1	35389	Interface cable assembly
	8.2	ea	1	12194	Control box bracket
	8.3	ea	1	35388	VR7000 control box
9.0					Misc.
	9.1	ea	6	15485	5/16" x 2 3/4" NC HHCS
	9.2	ea	1	32179	1993-1999 pulley drive hub
	9.3	ea	1	15490	Drive key
	9.4	ea	3	15251	5/16" x 1 3/4" NC HHCS
	9.5	ea	1	32178	2000 pulley drive hub

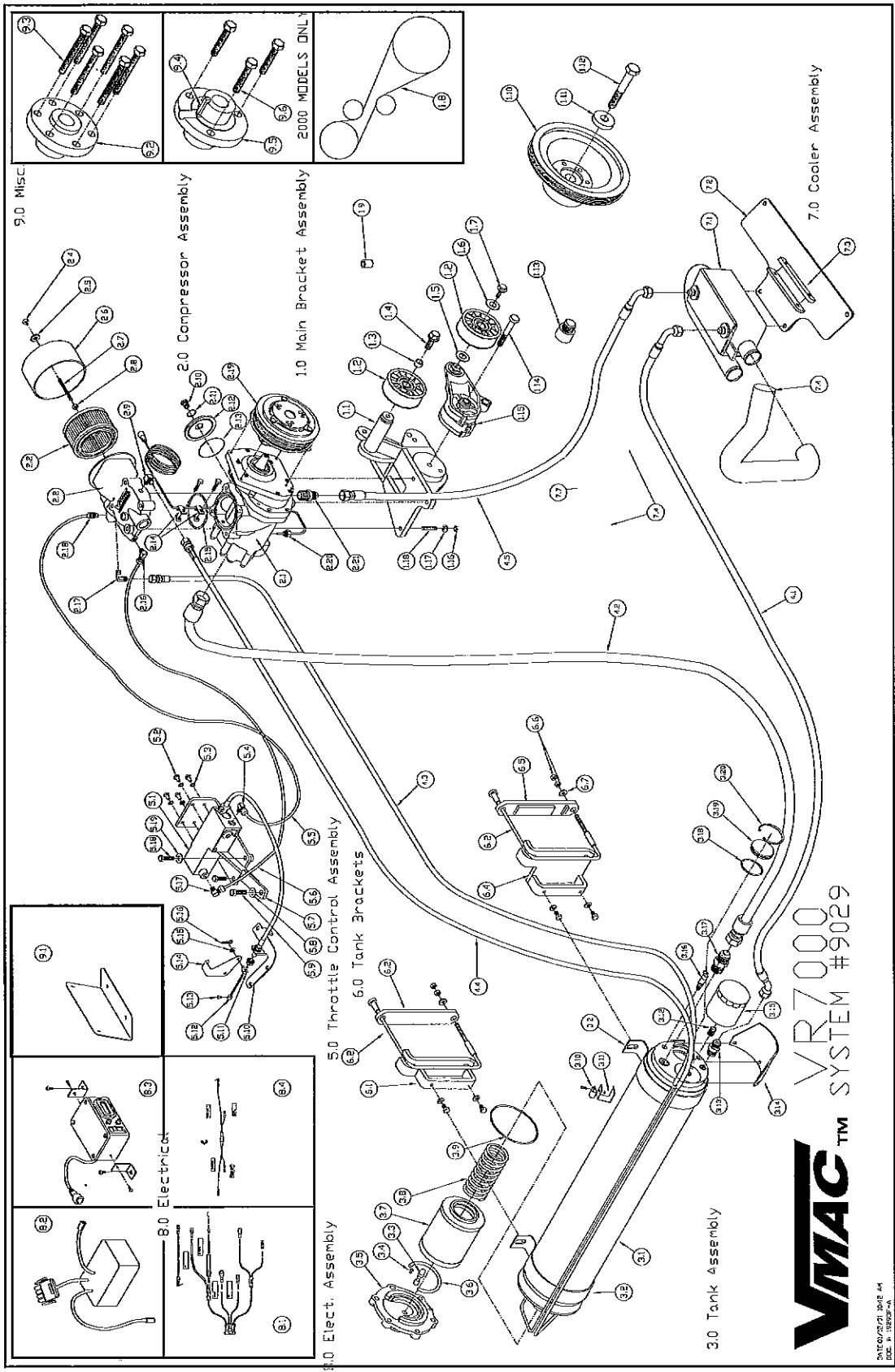

VMACTM VR7000 SYSTEM #9029

DATE: 02/21/01 3018 41
 DOC. # 139029-01