

**ILLUSTRATED PARTS LIST FOR SYSTEM 9022 - 1998-1999 FREIGHTLINER  
FL50,FL60,FL70,FL80 CATERPILLAR 3126 W/WOAC**

| ASSY.      | ITEM | UNIT | QTY | PART#        | DESCRIPTION                              |
|------------|------|------|-----|--------------|--|
| <b>1.0</b> |      |      |     | <b>48107</b> | <b>Main Bracket Assembly</b>             |
|            | 1.1  | ea   | 1   | 11116        | VR7000 main bracket                      |
|            | 1.2  | ea   | 1   | 13007        | Back idler                               |
|            | 1.3  | ea   | 2   | 14051        | Idler bolt spacer                        |
|            | 1.4  | ea   | 1   | 15161        | 5/8 x 1 ... NC G8 FI lock HHCS           |
|            | 1.5  | ea   | 1   | 26108        | Tensioner                                |
|            | 1.6  | ea   | 1   | 13008        | Ribbed idler                             |
|            | 1.7  | ea   | 1   | 15161        | 5/8 x 1 ... NC G8 FI lock HHCS           |
|            | 1.8  | ea   | 1   | 12163        | Remote idler mount                       |
|            | 1.9  | ea   | 1   | 16308        | VR7000 Belt                              |
|            | 1.10 | ea   | 2   | 18131        | VR7000 Pulley                            |
|            | 1.11 | ea   | 1   | 34022        | Fan Spacer                               |
|            | 1.12 | ea   | 6   | 34040        | Fan Spacer                               |
| <b>2.0</b> |      |      |     | <b>1259</b>  | <b>Compressor assembly</b>               |
|            | 2.1  | ea   | 1   | 1202         | VR7000 Compressor                        |
|            | 2.2  | ea   | 1   | 2035         | Clutch complete 6 groove                 |
|            | 2.3  | ea   | 1   | 58004        | O-Ring Viton 3 1/8 ID x 1/8 wide         |
|            | 2.4  | ea   | 1   | 22097        | Cable clamp                              |
|            | 2.5  | ea   | 1   | 35363        | Temperature probe                        |
|            | 2.6  | ea   | 1   | 12164        | Compressor Pulley Guard                  |
|            | 2.7  | ea   | 1   | 15029        | ... NC Nut Nylok                         |
|            | 2.8  | ea   | 1   | 15038        | ... Flat washer                          |
|            | 2.9  | ea   | 1   | 36042        | Filter Cover                             |
|            | 2.10 | ea   | 1   | 15374        | Threaded rod ... NC x 3                  |
|            | 2.11 | ea   | 1   | 15221        | ... NC Nut                               |
|            | 2.12 | ea   | 1   | 36037        | Paper Filter Element                     |
|            | 2.13 | ea   | 1   | 50081        | Elbow, brass NPT Tube, 1/8-5/16          |
|            | 2.14 | ea   | 1   | 49002        | Elbow steel JIC/ O ring, 5/8 - 16        |
|            | 2.15 | ea   | 1   | 58072        | Viton O ring 5/8 ID x 1/16 wide          |
|            | 2.16 | ea   | 1   | 15481        | O ring washer                            |
|            | 2.17 | ea   | 1   | 50020        | Elbow, Brass NPT- poly 1/8 ...           |
|            | 2.18 | ea   | 1   | 50085        | Elbow, NPT-SAE 45 Deg 1/8 ...            |
|            | 2.19 | ea   | 1   | 92175        | Inlet Control Valve Integrated long      |
|            | 2.20 | ea   | 2   | 15375        | M8 x 1.25 x 45 SHCS                      |
|            | 2.21 | ea   | 1   | 49032        | Connector 1 male BSPP- male 37 Deg. tube |
|            | 2.22 | ea   | 2   | 15427        | M8 x 1.25 x 60 SHCS                      |



**ILLUSTRATED PARTS LIST FOR SYSTEM 9022 - 1998-1999 FREIGHTLINER  
FL50,FL60,FL70,FL80 CATERPILLAR 3126 W/WOAC**

| ASSY.      | ITEM | UNIT | QTY | PART#       | DESCRIPTION   |
|------------|------|------|-----|-------------|---|
| <b>3.0</b> |      |      |     | <b>3044</b> | <b>Tank Assembly</b>  |
|            | 3.1  | ea   | 1   | 92199       | Main tank body  |
|            | 3.2  | ea   | 1   | 49035       | Nipple, steel straight thread -16                             |
|            | 3.3  | ea   | 1   | 49033       | NPT JIC steel connector                                       |
|            | 3.4  | ea   | 1   | 92039       | VR7000 oil filter   |
|            | 3.5  | ea   | 1   | 15385       | Retaining ring  |
|            | 3.6  | ea   | 1   | 32033       | Sight glass window  |
|            | 3.7  | ea   | 1   | 58008       | O-Ring 1 15/16 ID x 3/32 wide Viton                           |
|            | 3.8  | ea   | 1   | 12262       | Guard plate   |
|            | 3.9  | ea   | 1   | 50089       | 3/8 NPT 3/4 SAE Brass connector                               |
|            | 3.10 | ea   | 1   | 36054       | 200PSI Relief valve   |
|            | 3.11 | ea   | 1   | 58066       | O ring 4 ID x 1/8 wide Viton                                  |
|            | 3.12 | ea   | 1   | 58068       | Compression spring  |
|            | 3.13 | ea   | 1   | 36036       | Coalescing filter element                                     |
|            | 3.14 | ea   | 1   | 36064       | Tank rear cap seal  |
|            | 3.15 | ea   | 1   | 15077       | Button head SHCS  |
|            | 3.16 | ea   | 1   | 48241       | Scavenge screen barb assembly                                 |
|            | 3.17 | ea   | 1   | 32190       | Tank discharge cap  |
| <b>4.0</b> |      |      |     |             | <b>Hose kit</b>   |
|            | 4.1  | ea   | 1   | 17359       | Hose, AQP, 1/2 x 66.5 w/ 45 Deg elbow<br>(main air line)      |
|            | 4.2  | ea   | 1   | 17511       | Hose, HT w/tube assembly, 5/16 x 106.5<br>(scavenge line)     |
|            | 4.3  | ea   | 1   | 17510       | Hose, HT w/tube assembly ... x 109<br>(pressure control line) |
|            | 4.4  | ea   | 1   | 17360       | Hose, AQP w/elbow, 3/4 x 26<br>(compressor to cooler)         |
|            | 4.5  | in   | 36  | 17027       | Hose 150 Psi, 5/8   |
|            | 4.6  | ea   | 4   | 22029       | Clamp, hose HS10  |
|            | 4.7  | ea   | 1   | 17362       | Hose, AQP, 3/4 X 83<br>(tank to cooler)                       |
|            | 4.8  | ea   | 2   | 50006       | Hose barb 3/4 - 5/8   |
|            | 4.9  | ea   | 1   | 50070       | Hose Barb 3/4 - 5/8   |
|            | 4.10 | ea   | 1   | 49076       | Connector steel O ring 3/4 - 16                               |
|            | 4.11 | in   | 34  | 17027       | Hose, 150 Psi, 5/8  |
|            | 4.12 | in   | 60  | 17027       | Hose, 150 Psi, 5/8  |
| <b>5.0</b> |      |      |     |             | <b>Electrical</b>   |
|            | 5.1  | ea   | 1   | 5039        | VR7000 Throttle control                                       |
|            | 5.2  | ea   | 1   | 50020       | 1/8 NPT ... tube 90 Deg. Elbow                                |
|            | 5.3  | ea   | 1   | 92147       | Orifice fitting 90 Deg. Elbow                                 |
|            | 5.4  | in   | 18  | 17055       | ... black poly tube   |
|            | 5.5  | in   | 24  | 17055       | ... red poly tube   |
|            | 5.6  | ea   | 1   | 12198       | Throttle pull bracket   |
|            | 5.7  | ea   | 1   | 15405       | 8 x 32 x ... SHCS   |
|            | 5.8  | ea   | 1   | 32070       | Cable nipple  |

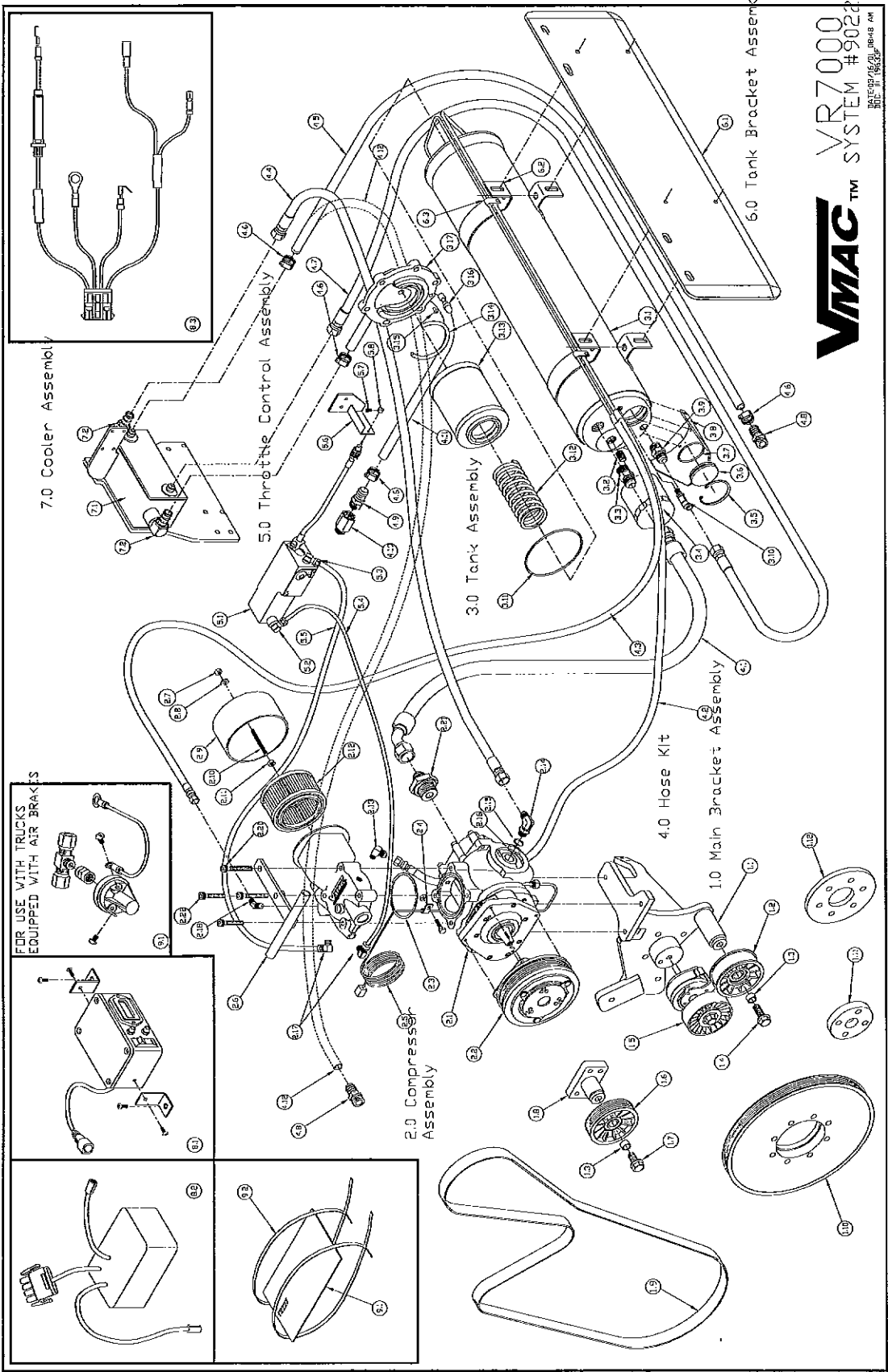

**VMAC**™  
**VR7000**  
 SYSTEM #9022  
DATE: 07/16/00