

**ILLUSTRATED PARTS LIST FOR SYSTEM V900054 - 1996-2000 GM C20/2500,
C/303500 & HD30/3500 6.5 L DIESEL 2 WHEEL DRIVE**

ASSY.	ITEM	UNIT	QTY	PART#	DESCRIPTION
1.0					Main Bracket Assembly
	1.1	ea	1	1100099	VR70 Main Bracket
	1.2	ea	1	2600103	Tensioner
	1.3	ea	1	1400129	Idler spacer
	1.4	ea	1	1300007	Idler, back
	1.5			OEM	C/W idler 1.2
	1.6	ea	1	1520419	12mm x 80mm HHCS
	1.7			OEM	C/W idler 1.2
	1.8	ea	1	1510161	½" x 1 ¼" NC flange lock
	1.9	ea	1	1400051	Idler bolt spacer
	1.10	ea	1	1300008	Idler, rib
	1.11	ea	3	1560008	8 x 1.25 nut
	1.12	ea	3	1570067	5/16 SAE washer
	1.13	ea	3	1500399	8mm x 38mm stud
	1.14	ea	1	3400036	Fan spacer
	1.15	ea	1	1800116	VR70 pulley
	1.16	ea	4	1520116	10mm x 100mm HHCS
	1.17	ea	4	1570044	3/8" SAE washer
	1.18	ea	1	1650222	VR70 belt
2.0				P120041	Compressor Assembly
	2.1	ea	1	P120002	VR70 Compressor
	2.2	ea	1	9200175	Inlet control valve
	2.3	ea	1	3500288	Pressure Sensor
	2.4	ea	1	5000112	1/8" NPT, 45 DEG street elbow
	2.5	ea	1	5000085	1/8" NPT to ¼" 45 DEG elbow
	2.6	ea	1	1550029	¼" NC Nylok nut
	2.7	ea	1	1570038	¼" SAE flat washer
	2.8	ea	1	3600045	Filter cover
	2.9	ea	1	1500374	¼" NC x 3" threaded rod
	2.10	ea	1	1500221	¼" NC nut
	2.11	ea	1	3600037	Paper filter element
	2.12	ea	1	5000081	1/8" NPT to 5/16" tube 90 DEG elbow
	2.13	ea	1	5830004	O-ring, 3 1/8" ID x 1/8" wide, Viton
	2.14	ea	1	4900036	¾" JIC swivel nut 45 DEG elbow
	2.15	ea	1	2200097	Cable clamp, ¼"
	2.16	ea	1	3550363	Temperature probe
	2.17	ea	1	9200103	Filter blank plate fitting
	2.18	ea	1	5830045	O-ring, ¾" ID x 3/32" wide, Viton
	2.19	ea	1	9200104	Filter blank plate
	2.20	ea	1	5830002	O-ring, 2 3/8" ID x 3/32" wide, Viton
	2.21	ea	1	5000060	Connector, ½" SAE x ½" NPT
	2.22	ea	1	P200035	VR70 Clutch



ILLUSTRATED PARTS LIST FOR SYSTEM V900054 - 1996-2000 GM C20/2500,
C/303500 & HD30/3500 6.5 L DIESEL 2 WHEEL DRIVE

ASSY.	ITEM	UNIT	QTY	PART#	DESCRIPTION
3.0				9203044	Tank Assembly
	3.1	ea	1	9200199	Main tank body
	3.2	ea	2	2200105	Mounting bracket 6" c-clamp
	3.3	ea	2	2200133	Tube clamp
	3.4	ea	1	4900035	3/4-16 threaded nipple
	3.5	ea	1	4900033	Steel connector, 3/4" NPT x 3/4" JIC
	3.6	ea	1	9200039	VR70 Oil filter
	3.7	ea	1	1500385	Retaining ring
	3.8	ea	1	3200033	Sight glass window
	3.9	ea	1	5830008	O-ring 1 15/16" ID x 3/32" wide, Viton
	3.10	ea	1	1200262	Guard plate
	3.11	ea	1	5000089	3/8" NPT x 1/2" SAE connector
	3.12	ea	1	3600054	200 PSI relief valve
	3.13	ea	1	5830066	O-ring, 4 3/4" ID x 1/8" wide, Viton
	3.14	ea	1	5840068	Compression spring
	3.15	ea	1	3600036	Coalescing filter element
	3.16	ea	1	3600064	Tank rear cap seal
	3.17	ea	1	1500077	10-32 x 3/8" SHCS button head
	3.18	ea	1	4800241	Scavenge screen assembly
	3.19	ea	1	3200190	Discharge cap
4.0					Hose Kit
	4.1	ea	1	1710334	5/16" HT hose / 85.5" c/w 90 DEG fitting (Tank to inlet valve)
	4.2	ea	1	1710444	3/4" AQP hose / 59.0" c/w 45 DEG fitting (Tank to compressor)
	4.3	ea	1	1710449	1/4" HT hose / 91.0" c/w 90 DEG fitting (Tank to inlet valve)
	4.4	ea	1	1710240	1/2" AQP hose / 33.5" c/w 90 DEG fitting (Cooler to compressor)
	4.5	ea	1	1710445	1/2" AQP hose / 83.0" c/w 90 & 45 DEG fittings (Tank to cooler)
5.0					Throttle Control
	5.1	ea	1	T510022	Throttle control

ILLUSTRATED PARTS LIST FOR SYSTEM V900054 - 1996-2000 GM C20/2500, C/
303500 & HD30/3500 6.5 L DIESEL 2 WHEEL DRIVE

ASSY.	ITEM	UNIT	QTY	PART#	DESCRIPTION
6.0					Tank Brackets
	6.1	ea	2	1200236	Tank strap mount
	6.2	ea	2	2200111	Tank strap flat bar
	6.3	ea	2	2200117	Tank cable strap
	6.4	ea	4	1400162	Cable spacer
7.0				4800238	Cooler Assembly
				9200200	Cooler
	7.1	ea	1	2200026	Hose clamp HS28
	7.2	ea	6	1710447	Rad hose
	7.3	ea	1	1710448	Rad hose
	7.4	ea	1	1710243	Rad hose connector tube
	7.5	ea	2	2200132	Cooler backing strap
	7.6	ea	1		
8.0					Electrical
	8.1	ea	1	3550404	Control box
	8.2	ea	1	3550412	Switching box
	8.3	ea	1	3550518	Drive disable circuit
	8.4	ea	1	3550521	Interface cable
9.0					Misc.
	9.1	ea	1	2200112	Tank strap flat bar
	9.2	ea	1	2200115	Tank cable strap

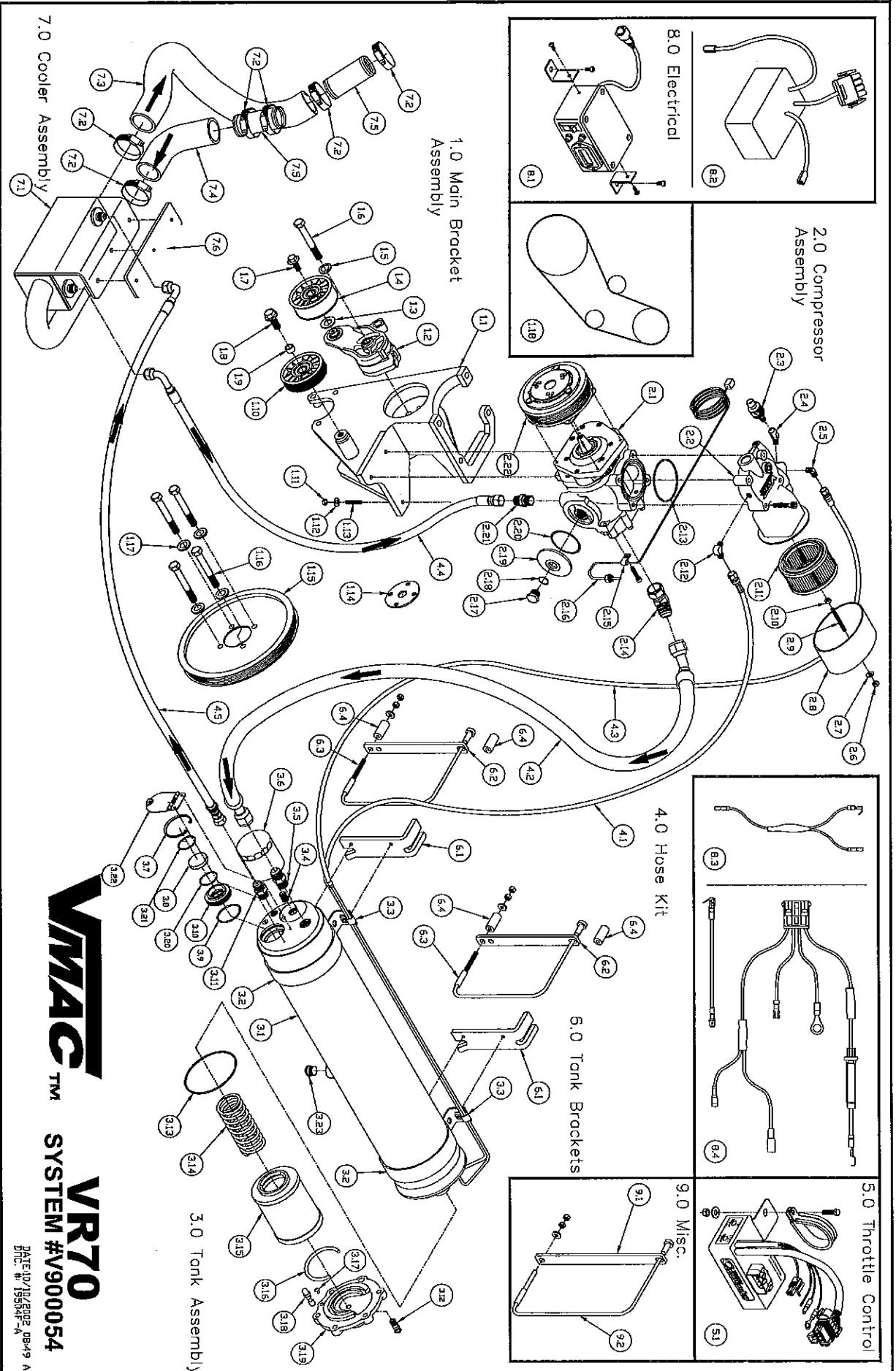

VMAC™ **VR70**
 SYSTEM #V900054

PATENT # 195802 08-19 AM
 DTL # 19584F-A